

**RESOLUTION NO. 2019-007**  
**RESOLUTION TO VACATE A COUNTY ROAD**

WHEREAS, in accordance with Iowa Code section 306.10 and 306.11, the following described portion of Road #7 of 1868 has not been traveled for several years and a public hearing is not required in order to vacate said road; and

WHEREAS, no objections have been received, either in writing or by persons present at the open meeting held on May 14, 2019;

The portion of Secondary Road described as:

That Portion of Indian Creek Street, originally established (Road #7 of 1868) on August 22nd, 1868 (See Road Record South Book, page for Cass Twp. Section 5) lying in Parcel "A" of the NW 1/4 of the SW 1/4 of Section 5, T-75N, R-37W as recorded in Book 5, Page 235 (Plat of Survey for Duane Weirich) in Cass County, Iowa. The intention of this road closure is to vacate that untraveled portion of Indian Creek Street (33 feet wide) within said Parcel "A". The traveled portion of Indian Creek Street will not be affected by this road vacation.

The area so vacated shall revert to the adjacent owners of record as of the date of this order.

NOW THEREFORE BE IT RESOLVED by the Cass County Board of Supervisors that the subject section of road be ordered vacated and closed.

Vote: For passage- Frank Waters, Stephen Green, John Hartkopf, Mark O'Brien and Steven Baier.

Carried unanimously. Resolution Adopted.

Resolution adopted this 14th day of May, 2019.

/s/-Steve Baier, Chair

Attest: /s/-Dale Sunderman, Auditor

ROAD VACATION  
WEST 33 FEET  
OF PARCEL "A".

T-75N

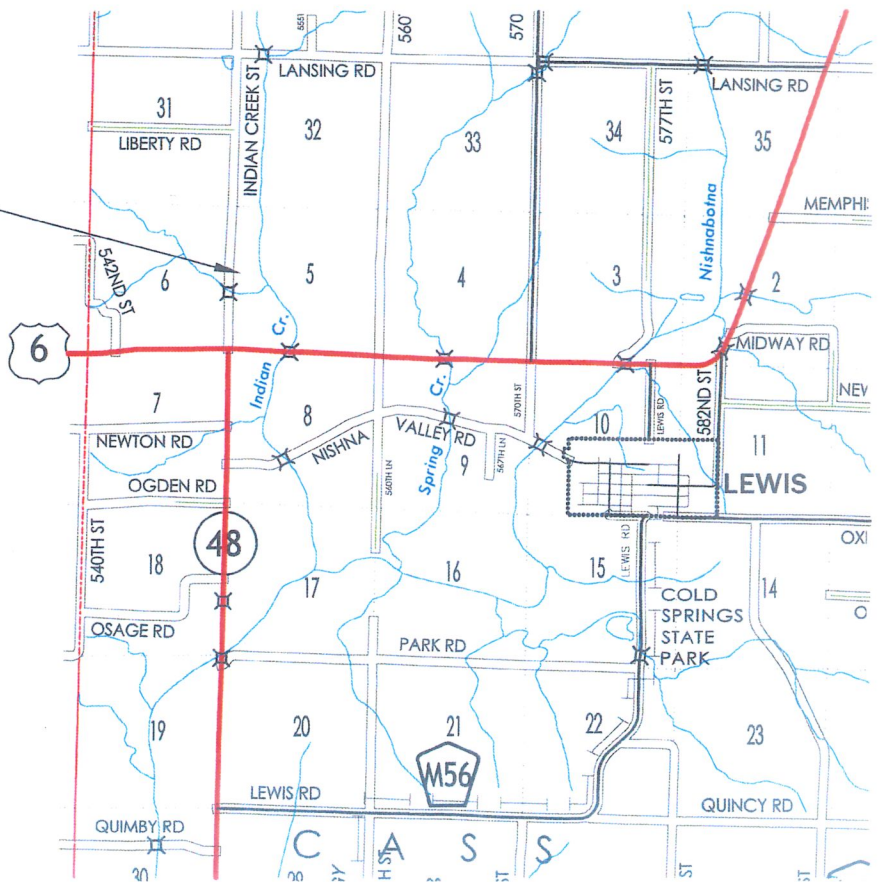

### PLAT OF SURVEY

PARCEL A AND PARCEL B OF THE NW1/4 SW1/4 OF SECTION 5, T75N, R37W OF THE 5TH P.M., CASS COUNTY, IOWA

PARCEL A BOUNDARY LINE TABLE

LINE	BEARING	DISTANCE
L1	S87°52'26"E	378.15'
L2	S04°51'50"W	753.07'
L3	S80°02'42"W	76.19'
L4	N71°55'18"W	263.05'(M&S)
L5	N00°54'41"E	856.02'
L6	S87°52'26"E	1944.48'

PARCEL B BOUNDARY LINE TABLE

LINE	BEARING	DISTANCE
L7	S00°51'21"W	532.87'
L8	N27°39'53"W	99.47'
L9	S47°22'48"W	727.87'
L10	S55°28'41"W	209.71'
L11	N77°33'18"W	90.76'(M&S)
L12	N85°37'18"W	199.54'(M&S)
L13	S85°49'42"W	244.20'(M&S)
L14	S80°02'42"W	83.26'
L15	N04°51'50"E	753.07'

CENTERLINE OF 25' WIDE INGRESS & EGRESS EASEMENT LINE TABLE

LINE	BEARING	DISTANCE
L20	S54°01'17"E	48.67'
L21	S63°50'57"E	61.24'
L22	S74°27'13"E	80.07'
L23	N87°00'49"E	42.23'
L24	N68°01'26"E	39.03'
L25	N47°59'04"E	117.95'

CENTERLINE OF 20' WIDE WELL & WATER LINE EASEMENT LINE TABLE

LINE	BEARING	DISTANCE
L26	N64°58'23"E	153.35'
L27	N84°39'35"E	180.53'
L28	N87°37'11"E	1345.14'

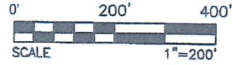
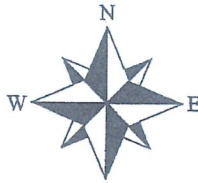

LEGEND

- ▲ SECTION OR SUBDIVISIONAL CORNER MONUMENT (MATERIAL AS NOTED)
- SET 5/8" DIA. BY 24" REBAR W/ORANGE CAP PLS #17048
- FND. 3/8" DIA. REBAR IN CONCRETE MONUMENT AS COUNTY ROAD P.I.
- (M) MEASURED DISTANCE
- (R) RECORD DISTANCE
- (S) DISTANCE FROM PLS #6711 SURVEY IN BK. 3 ON PG. 713

